



إدارة ومتابعة المشاريع ذ.م.م.
Project Management and Control w.l.l.
A member of PMC International Ltd.

PROJECT MANAGEMENT AND CONTROL

Since 1981

COMPANY PROFILE
- 2026

BUILDING A BETTER FUTURE,
ONE PROJECT AT A TIME.



إدارة ومتابعة المشاريع ذ.م.م.
Project Management and Control w.l.l.
A member of PMC International Ltd.

“Planning is bringing the future into the present so that to do something about it now.”

The President Message

As we at PMC enter our 5th decade of operations, we are continuing to build upon our first forty years of success and are already in the process of both re-evaluating and re-aligning new directions for the firm and its professional goals, to meet the new challenges of tomorrow's ever-changing marketplace.

We are preparing to enhance our already proven and successful range of services to diversified markets by launching unique services and management models including Artificial Intelligence tools bringing about improved efficiency, enhanced decision-making, and effective resource management. By leveraging AI tools, our project managers can analyze vast amounts of data to predict project outcomes, identify potential risks, and optimize workflows.

I believe when AI augments project planning by automating tasks, optimizing resources, and predicting risks, human oversight remains crucial. Effective implementation hinges on quality data that PMC already has from its successful projects. The goal is a symbiotic relationship where AI enhances human decision-making, not replaces it.

PMC emphasizes establishing a positive link between professional Project Management techniques and greater return on Investment, in emerging markets such as those of the MENA region. The new directions and challenges are already proving to be an exciting and stimulating impetus for our team of professionals who continue to excel in their respective disciplines.



“Management is, above all, a practice where art, science, and craft meet

*Henry Mintzberg,
Professor of Management Studies*

Who We Are & What We do

PMC is a Kuwait-based project management firm founded in 1981 in the UK and was subsequently registered as a Kuwaiti company in 1985. The firm is a recognized regional leader in providing high-quality advisory services, earning an esteemed reputation for working on some of the most prestigious projects in Kuwait and MENA region.

PMC also has an official registration and presence in the emerging and promising market of Kurdistan. PMC is providing supportive consultancy services to many Kurdish governmental entities in Project Management, Feasibility Studies and Capacity Building. Through our supportive programs in Kurdistan region, PMC has initiated a non-profit program to support Kurdish society needs in capacity building through many training opportunities in diversified engineering and consultancy fields.

PMC has earned a reputation for working on prestigious projects and has executed total projects in excess of \$4 Billion USD representing over three million m² of built-up space.

PMC provides value-added tailor-made services designed to meet and exceed our client's needs and expectations.

Our team is dedicated to providing the highest quality of service, innovative solutions and expertise to fully respond to the anticipated needs of an expanding client base.

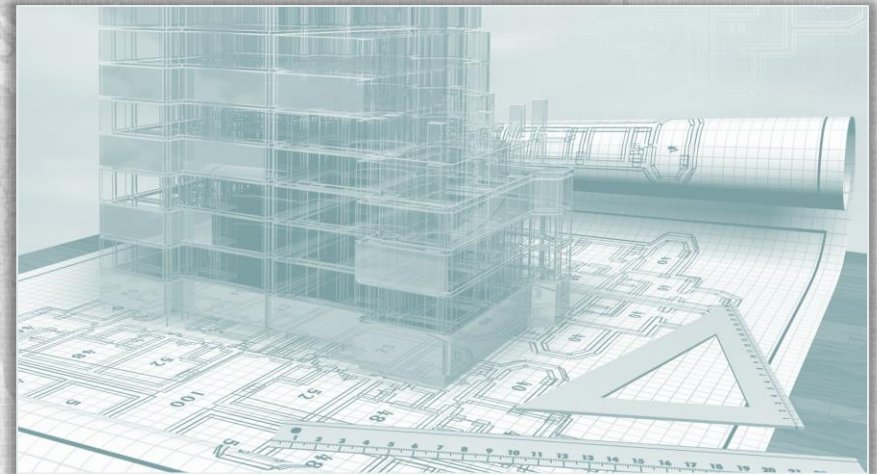

“The best way to make our dreams come true
is to wake up.”

Paul Valery, Poet

Business Philosophy

- Provide the highest quality service to private owners, governmental authorities, designers, contractors and developers in a wide range of sectors.
- Form long-lasting collaborative and mutually rewarding relationships with each and every client.
- Help clients achieve their goals in an ethical, creative, innovative and cost-effective manner.

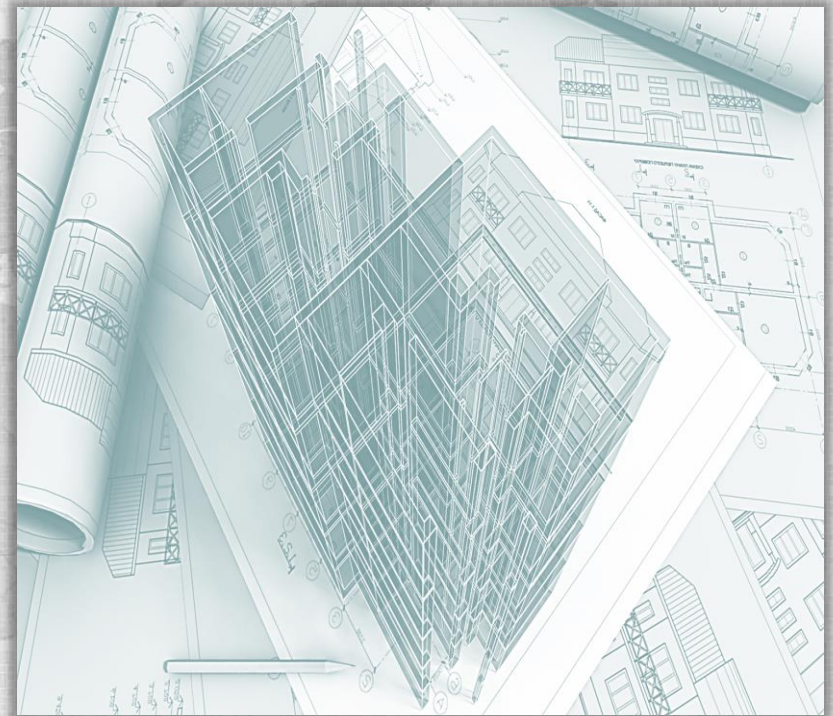

“Experience tells us what to do;
confidence allows us to do it.”

Stan Smith

Technical Expertise

PMC's professional staff represents an unsurpassed pool of multidisciplinary talents. Our core staff includes Civil Engineers, Architects, Designers, Urban Planners Economists, Lawyers, Policy Analysts, Industry Specialists, Financial Analyst and Professionals with years of experience in projects and construction management, facilities, infrastructure, environment, tourism, customs, investment promotion, industrial estate development and operation.

We employ both local and international staff in nearly every country where we operate, allowing for the implementation of international best practices with sensitivity to the unique attributes of the local economy, customs and development priorities.

In bringing together local and international practitioners, our team harnesses both the professionalism of industry



PMC employs both local and international staff in nearly every country in which we operate

“Good buildings come from good people,
and all problems are solved by good design.”

Stephen Gardiner

Key Personnel

Mahmoud Nayef Dalloul **President & Chief Executive Manager -** **(Kuwait)**

Eng. Mahmoud Dalloul is the President and CEO of PMC. He obtained his B.Sc (Hons) in Civil Engineering from The City University, London, 1979 and M.Sc in Construction Management in 1995. He is a member of the Kuwait Society of Engineers, the Institution of Civil Engineers, UK and the American Association of Cost Engineers. He is also a Claims Consultant, an Arbitrator and a Design Consultant.

Before joining a young and emerging PMC in 1984, Mahmoud worked for a medium size contractor as a Project Manager. By 1989, he was appointed PMC's General Manager, Director and a shareholder. In 2005, Mahmoud became the President and CEO of PMC and is still serving as such to date.

With forty years of experience in project management and nearly forty years serving as part of PMC's legacy, Mahmoud has contributed to the development of various projects management systems and acted as a member of many technical and advisory panels in the field, both regionally and internationally. He has also led a diverse portfolio of projects, including a practical top-to-bottom involvement in oil sector operations in Kazakhstan to the provision of uncompromising quality services to the community.

Mahmoud is actively involved in each of PMC's current projects, providing visible and valuable input and experience. Since assuming the role of President and CEO, Mahmoud has planned and executed a complete restructuring of PMC and turned it into a multi-disciplined firm, offering services in Design, Project and Construction Management, Construction Claims and their Defense, as well as IT division providing innovative high end solutions and service to that market sector.

Adnan Ali Eid - **Vice President & Chief Operating Manager -** **(Kuwait)**

Eng. Adnan Ali Eid has over 34 years of diversified experience in project management, analysis, implementation, and technical support, and is currently the Vice President/Chief Operations Manager at PMC.

He has a background in telecommunications engineering and has diversified experience in the Management, Analysis and Implementation of Integrated Security Systems, Process Control, Information Technology, Telecommunications, Medium Voltage, Warning and Environmental monitoring networks.

Before joining PMC, Adnan's role was a Managing Director with several contracting companies where he managed and administered projects in Telecommunications and Data Transmission Networks, Fiber Optic Networks, NBC Warfare Detection and Warning Systems, NBC Shelters, IT Networks and Software Packages, Medium Voltage Transmission and Substations, Fleet Tracking System, SCADA Management software development, Electromagnetic Pulse Filters for NBC shelters power, and data systems, Multimedia Packages, Technologies Studies and Analysis, Mobile and fixed Environmental and Telecommunications Laboratories, Medical Laboratories and Low Voltage Instrumentations.

With years of extensive and practical experience, Adnan has amassed capacity to undertake roles as diverse as consulting, project management and monitoring, research and training, complemented with demonstrated communication, analytical, team building and organizational skills. Adnan Eid graduated in Telecommunications Engineering from the Moroccan Ministry of Telecommunications school in 1980.

Mohammad Anwar Rashad **Vice President & Gas /Oil Manager**

Anwar Rashad is a Chartered Mechanical Engineer (B.Sc. Honours Mech Engineering and M.Sc. Manufacturing Technology from City University of London) with extensive Project Management and Dispute/Claims management experience gained over 34 years in managing execution of major EPC Projects for the Oil, Gas, Petrochemical and Power working with major clients in Kuwait and the GCC countries, both in the private and public sectors.

Anwar's work spans many sectors with a particular focus on defining strategies for projects execution, cost control, and disputes resolution arising out of claims and arbitration, on large scale EPC Oil and Gas Projects.

Some of the major projects Anwar was involved in were:

Kuwait's Clean Fuel Project, with KNPC; DCFUP EPC Project, with Qatar Petroleum Company; EPF for Kuwait Oil Company (KOC) and 2,500 MW CCGT Power Plant for MEW, Kuwait; Rehabilitation of Oil & Gas South Oil Company in Iraq (2003-2006).

“Trying to manage a project without project management is like trying to play a football game without a game plan.”

Karen Tate

Key Personnel

Mohammad Magdi Rashad **Sr. Vice President District** **Cooling System Manager**

Mr. Magdi has over 35 years of professional experience in District Cooling System covering a wide range from inception and planning to design, project/construction management, contracting and operations. He has worked extensively on large-scale prestigious projects in the UAE, Kuwait, Saudi Arabia, the UK and the USA. He is an expert in thermodynamics with an excellent working knowledge of building energy.

Prior to joining PMC, Mr. Magdi was the Business Development Director of Saudi Tabreed, Infrastructure Coordinator for Hill International in Abu Dhabi, Manager of Projects for UDCH-Kharafi National, Building Services Manager (Bovis, UK) and Building Services Manager (Courtaulds Engineering Ltd UK).

Mr. Magdi is a Chartered Engineer (UK), a Member of the Chartered Institute of Building Services (UK), a Life Member of the Kuwait Society of Engineers, and a Member of American Society of Heating, Refrigerating and Air-Conditioning Engineers (ASHRAE). He has a Mechanical Engineering degree from Middlesex University, an MSc in Thermodynamics from Birmingham University and has researched Islamic Architecture at Cambridge University (UK). He is also a PhD Researcher in Energy in Buildings at Brunel University (UK).

Nassib Kawar **MEP Manager (Jordan)**

Eng. Nassib Kawar is PMC's MEP Manager and has over 33 years of experience in his profession. His impressive leadership skills in MEP were gained from his previous projects as a mechanical site engineer responsible for the design, procurement and shop drawings relative to the MEP.

He earned his degree Bachelor of Science in Mechanical Engineering from City University London, in 1980.

Tareq Bahzad Awais **Architect**

Eng. Tareq Awais is a certified and licensed architect with over 24 years of Architectural Design/Build experience in the development of a construction project.

He is an active member of the design department at PMC and is responsible for organizing and coordinating all aspects associated with project pre-construction and construction phases including, the preliminary and detailed project Quantity Take-Off, essential for the development of the analysis and estimation process of project cost and time. He also provides architectural design adjustments and solutions as seen applicable, as well as the Review/update of project documents.

He obtained a Bachelor of Architecture degree in 1990 from the Central University of Las Villas, Cuba.

“The goal of management is to remove obstacles.”

Our Services

Paul Orfalea

Our priority is to meet client needs and budget goals while providing the highest standard of services in a most efficient and effective manner.

PMC provides a complete range of services from the earliest planning stage right through to final project closeout, post status, operation and maintenance.

PMC provides custom-made project management services designed to meet and exceed our client's needs and expectations.

PMC is dedicated to providing the highest quality of service, innovative solutions and the corporate depth and diversity to fully respond to the anticipated needs of an expanding client base, working in cooperation with international and bilateral funding agencies as well as host country governments.

PMC is acknowledged for its value added contribution to a variety of projects, private and governmental, large and small in scope. These achievements have been accomplished with the application of PMC's proprietary Project Management Model, together with its technical knowledge and resource base.

PMC has developed a recognized capacity and specialized expertise in the development and implementation of innovative techniques and methodologies to rapidly assess and analyze the various components of a project.

“A good system shortens the road to the goal”

Our Services

Orison Sweet Marden

Design Management Services

- Project Mobilization Plan
- Organization & Communication
- Program Evaluation
- Design Standards
- Financial Planning
- Cost Control
- Market Analysis
- Soliciting Bidder's Interest
- Design Development
- Schedule Control Progress
- Meetings
- Governmental Interface
- Code Compliance
- Design Status Reports
- Construct ability Analysis
- Construction Strategy
- Temporary Facilities
- Contractor Pre-qualification
- Contracts & Agreements

Construction Management Services

- Pre-construction Meetings
- Procedures Manual
- Progress Meetings
- HSES Contracts/Monitoring
- Progress Tracking
- Deliverables Inspection
- Quality Control
- Change Orders
- Payments Authentication
- Claims Management
- Testing & Commissioning
- Schedule Punch
- Project Records
- Final Accounting
- Facility Management
- Close-out

Other Services

- Value Engineering
- Project Strategy Development
- Planning / Scheduling / Cost Engineering
- Environmental Management Consultancy
- Financial Consultancy
- Feasibility Studies
- Environmental Impact Assessment
- (EIA) Studies
- Engineering, Procurement
- Construction Management
- Transaction Advisory Services
- Public Private Partnership
- Claims Management

“Beware of little expenses; a small leak will sink a great ship.”

Benjamin Franklin

Certificates & Licenses

Throughout the years PMC has acquired assorted commercial licenses to provide integrated engineering & consultancy services to our clientele.

- 1. Project Management**
 - Planning Decision Advisory
 - Project Controls (Time, Cost, Quality)
- 2. Real Estate Development Management**
 - Feasibilities Marketing
 - Sales Logistics.
- 3. Property Management**
 - Facility Management Security
 - Automation Leed Assessment
- 4. Insurance Management and Consultancy**
 - Project & Portfolio
 - Protection Programs
- 5. Exhibitions & Conferences Management**
 - Design Planning
 - Organization Marketing
- 6. Economic Consultancy**
 - Research Analysis
 - Reports / Impacts Studies
- 7. Financial Consultancy**
 - Investments Studies
 - Project Auditing Accounting
- 8. Marketing Consultancy**
 - Research Markets
 - Trends Studies
- 9. Industrial Consultancy**
 - Technologies Planning
 - Feasibilities Manufacturing
- 10. Environmental Consultancy**
 - EIA & Social Impacts
 - RAP (Resettlement Action Plan)
- 11. Communication Technology Consultancy**
 - ICT Solutions PMIS
 - BIM Networks Site Surveillance
- 12. Administrative Consultancy**
 - ERP Restructuring
 - Policies Frameworks
- 13. Petroleum Consultancy**
 - Oil & Gas Technologies Project Controls
 - HSE and Security
- 14. Vocational Training**
 - Training Centers Program Design
 - Workshops Certification

All of our certifications are reflective of the diversified expertise of PMC's team in cost, time and quality management and efficient decision-making

project failures have more to do with behavioral shortcomings, poor employee morale, negative human relations, low productivity, and lack of commitment.”

International Affiliations

Harold Kerzner

Since its inception, PMC has affiliated with a number of renowned firms to deliver high quality state of the art services to clients. PMC worked with numerous clients on different projects ranging from projects of national significance to specialized. This resulted in client relationships that developed into long-term alliances.

- LYON-USA
- Aegis, International - France
- Organic Waste Systems (OWS) N.V - Belgium
- Madi and Partners Consulting Engineer - Jordan
- CPCS Transcom International Ltd Canada
- AECOM Int - USA
- Tivenca- Venezuela
- Vector Management , UK
- Careyjones- UK.
- Arabtech Jardanah, Jordan
- White & Case LLP UK
- Stantec Inc UK
- Clark Engineering
- DMJM International - USA
- Interdisciplinary Research Consultants (IDRC)
- Libra Law Firm UK
- SMEC International Pty Ltd
- Clyde and Company UK,
- Consolidated Consultant
- Al Jidara, Jordan
- Group Five International
- Posford Haskoning Environment Co
- Medhat Abozeid MZEEH Egyptian
- Consulting House
- ICN Design International Pte Ltd.
- DP Consultants Pte Ltd- Singapore
- SCB International LLC
- SWA Group-Houston
- Vanir Construction Management \ INC / USA
- Hochtief Facility Management- Germany
- American University of Beirut-
- Research Lebanon
- EcoPhile Co, S. Korea
- Ellis Taylor (Solicitors)-UK
- Centre International de Development
- Plasco Energy Co.Canada
- CorEnt Group- S. Korea
- Durable et des Ressources Humaines
- Conserve Consultants PVT Ltd-India
- {CID-RH) Benin.

“Set realistic goals, keep re-evaluating, and be consistent.”

International Registrations

Venus Williams

- ❑ TQUSI [ISO 9001:2008 | ISO 14001:2004].
- ❑ American Academy of Project Management (MPM).
- ❑ American Association of Financial Management (MFM).
- ❑ Society of Value Engineers (SAVE).
- ❑ US Green Building Council.
- ❑ Construction Management Association of America (CMM).
- ❑ Associate Members-Water Environment Federation.
- ❑ National Council for Public Private Partnerships.

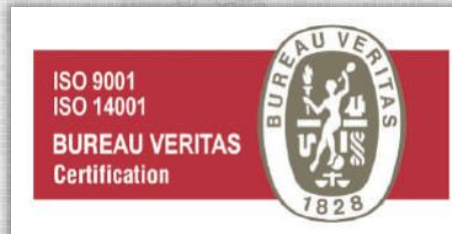

“Time is the scarcest resource and, unless it is managed, nothing else can be managed.”

Peter Drucker

Registrations in the State of Kuwait

- Kuwait Chamber of Commerce & Industry
- Ministry of Commerce and Industry
- Central Tenders Committee (CTC)
- Ministry of State for Development Affairs-
- Consultants Selection Committee- State of Kuwait
- Kuwait Environmental Protection Authority - (KEPA)
- Ministry of Finance - (MoF)
- Public Authority for Applied Education & Training - (PAET)
- Public Authority for Applied Agricultural and Fish Resources
- Kuwait Investment Authority
- Ministry of Health
- Ministry of Awqaf and Islamic Affairs
- Public Authority for Housing and Welfare
- Kuwait National Guard
- Kuwait Oil Company (On-Going).
- Kuwait Society of Engineers (KSE)
- Kuwait Information Office (KIO)
- Kuwait National Petroleum Company (KNPC)
- Kuwait Public Authority for Industries (PAI)
- Vice-President Office-Planning Department-
- Kuwait University
- Partnership Technical Bureau (PTB)

“In an agile project the team takes care of the tasks and the project leader takes care of the team.”

Jim Highsmith

Regional Registrations

- ❑ Ministry of Trade and Commerce-Companies Control Department- Jordan
- ❑ Masdar City-UAE
- ❑ Abu-Dhabi Housing Authority - UAE
- ❑ Lebanese Orders of Engineers and Architects - Lebanon
- ❑ Gulf Organization for Industrial Consulting
- ❑ Funding Agencies
- ❑ Kuwait Fund for Arab Economic Development - (KFAED) - Kuwait
- ❑ Arab Fund for Economic and Social Development - (AFESD)- Kuwait
- ❑ United Nations Economic and Social Commission of Western Asia - (UNESCWA)
- ❑ World Bank- DG Market and Consultancy.

“Focus on idle work not on idle workers,
In order to achieve fast, flexible flow.”

Sustainability – Track Record

Ken Rubin

PMC strives to achieve a sustainable workplace, prioritizing safety, ethics, diversity and commitments. We believe that with a sustainable workplace and business ethos, we can contribute to a more sustainable environment.

Within six months of PMC's registration with the U.S. Green Building Council, PMC succeeded in having the project listed by the Vice President of McGraw-Hill Construction Committee for Industry Analytics, Alliance & Strategic Initiatives earmarked the New Central Bank of Kuwait-Headquarter Building as one of the three Green Building Activities of MENA Region aside with (Bahrain World Trade Center and Masdar City) in the International Conference in "China Green Building & Energy Efficiency Conference - September 19, 2008-Shanghai, China.

In addition, we have incorporated a paperless/reduction program, Leed Certified office carpet and segregation of wastes. We have initiated the PMC Environmental Savings Calculator and produced our 2009 brochure on recycled paper. PMC is aiming to fulfill the requirements of the Global Reporting Index (GRI) and its office premises operate and abide with the standards and procedures of PMC's Environmental Management System ISO 14001..

“Managing projects, people, conversations, and resources are all part of a puzzle that cannot be solved without the leadership mindset.”

Sandeep Kashyap

Offices & Contacts

Project Management and Control w.l.l - Kuwait

Fahed Al-Salem Street, Salhia Tower, 7th Floor,
P.O.Box:- 23598, Safat:- 13096, Kuwait
Tel: +965 2241 4571 | 81 | 2245 3549,
Fax: +965 2245 3548
Email: info@pmc.com.co
www.pmc.com.co

PMC Hashemite Kingdom of Jordan--Amman

Future Project Management and Conttol
Um-Uthayna, Saed Ibn Abi Wakkas Street,
Abu Zaid Center, Building No. 35, 4th Floor,
P.O.Box: 941683, Amman 11194, Jordan
Tel: +962 6 5540 686
Fax: +962 6 5540 676

PMC-London-United Kingdom

44/45 Chancery Lane
London WC2A 1 JB UK
Tel: +44 0 20 7405 0206
Fax: +44 0 20 7404 1191

Project Management and Control - Kurdistan,Iraq

Erbil- Bakhtiari-
facing Media School-Building 1, Office 1.
Kurdistan.Iraq.



إدارة ومتابعة المشاريع ذ.م.م.
Project Management and Control w.l.l.
A member of PMC International Ltd.

Since 1981

SELECTION OF WORKS

Kuwait

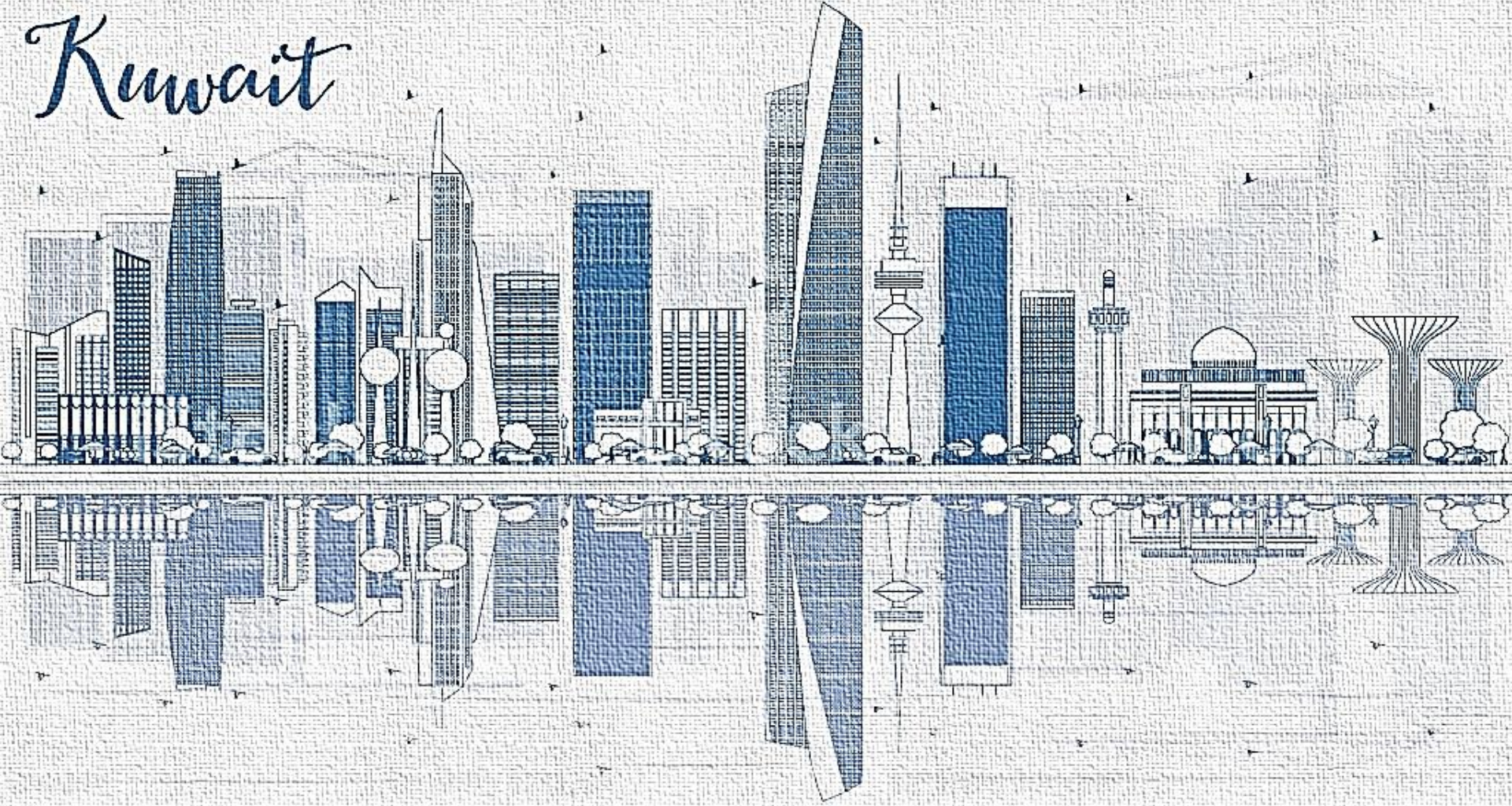

إدارة ومتابعة المشاريع ذ.م.م.
Project Management and Control w.l.l.
A member of PMC International Ltd.

Central Bank of Kuwait



Kuwait City,
KUWAIT

Kilani Hospital

Amman,
JORDAN



AL Ahli Bank

Kuwait City,
KUWAIT



Hard Rock Kuwait

Salmiya City,
KUWAIT



Dead Sea Resort Spa and Hotel



Dead Sea,
Jordan

Dead Sea Resort Spa and Hotel Facility.
Dead Sea, Jordan

The Dead Sea Resort and SPA Project is comprised of 16 clusters units (single rooms, duplexes and suites). Each cluster has its own swimming pool and pool outlets (pool bars, snack outlets). The site was fragmented into 6 areas served by 3 complete main areas facilities.

Dead Sea Resort Spa and Hotel



Bouznika,
Morocco

Dreams Buildings Project-
in Bouznika Morocco

Dreams Buildings Project is a mixed usage development for hotel, residential and leisure. It is located on a land site of 61,860 m² site; on Casablanca-Rabat Highway facing the Atlantic Ocean.

PMC PROJECTS - REFERENCES

Infra-Structure & Civil Works

Project Name	Period From / To	Brief Description of Project	Client	Approx. value (in Million US\$)	PMC Role.
Development of EIA, Detailed Design and Supervision of Construction Works of Zhove Irrigation Project-Zimbabwe.	Feb 2020 On-Going	The project entails the construction of a conveyance system to supply adequate and sustainable water from Zhove Dam to irrigate about 2,500 hectares of agricultural land in Beitbridge District,-South Province of Zimbabwe.The project is divided into three activities, as follows -Carry out an Environmental Impact Assessment (EIA).-Carry out a detailed engineering designs document and Supervision of the construction works.	Govt. of Zimbabwe through the Ministry of Lands, Agriculture, Water and Rural Resettlement with the support of Kuwait Fund.	3.11	Carry out detailed engineering design documents. Carry out detailed analysis and evaluation of tender submissions for the award of contracts.
New North Dual Link Road	May 2010 Mar 2012	A New North Dual Link Road connecting Ahmadi Town. The same is from Road 212 at its junction of Highway 211 with route 40. The North Link Road consists of a three lanes dual carriage way and would be and Additional major entrance to Ahmadi town.	Kuwait Oil Company, Ahmadi, Kuwait.	4.93	Preparation and Provision of Health, Safety and Environmental Program.
The Construction and Maintenance of the Logistic Supply Camp at Julaiha, Kuwait	Sept 2013 July 2015	The project is a logistics supply camp which comprises of 1-Head Quarter Building, 2-Soldiers Sleeping Building, 2-Officers Sleeping Building, 1-Workers Sleeping Building, 1-Indoor Stadium, 1-Mosque, 1-Clinic Building, 1-Communication Center, 1-Helipad, 1-Gas Room, 1-Pump House, 2-Utility Building, 1-Water Tank, 1-Irrigation Pump House and Water Tank, 3-Main Gate House Building and Infrastructures Development.	Al-Tawbad General Trading and Contract. Co. (w.l.l). - Kuwait Ministry of Defense. Kuwait.	38.76	Project Management & Consultancy Services
Abdally Economic Zone	Sept 2017 July 2021	A Concept Design with 4 networked plants, each with a cooling capacity equal to 12,000 TR in chillers and with a total Thermal Energy Storage equal to 6,000 (TES). It is a Mixed use development, (residential, commercial and industrial) - with a gross floor area (GFA) of 1.8 million m ² .	Kuwait Direct Investment Promotion Authority- KIDPA	3.65	Design & Consultancy Services
Sabah Al Ahmad Logistics Park - (Kuwait).	Sept 2017 July 2021	It is a landmark logistic city with a cooling capacity equal to 3,000 TR in chillers. It is a Full design of District Cooling system	Kuwait Direct Investment Promotion Authority- KIDPA	5.35	Design & Consultancy Services

PMC PROJECTS - REFERENCES

Feasibility / Environmental Studies

Project Name	Period From / To	Brief Description of Project	Client	Approx. value (in Million US\$)	PMC Role.
250 MW Solar Power Station - Kuwait - Al-Abdaliyah	August - 2025 On- Going	EPC project on a Power Purchase Agreement base - Kuwait Ministry of Electricity and Water and Renewable Energy (MEWRE) - 250 MW solar power production station. Project Area 2.7Km ²	Power China Chengdu Engineering Corporation Limited	0.041	Provision of technical services and a Renewable Energy ESIA study to satisfy SPIC feasibility Study and fulfil Kuwait Environment Public Authority (KEPA) approval requirement
EIA, Social Study, Resettlement Action Plan	Oct 2014 Jan 2016	Environmental and Social Studies Impacts Assessment and Resettlement Action Plan	World Bank. - Ministry of Works- Kurdistan- Iraq	0.400	Management and Studies Services
Feasibility Study and Implementation of Action Plan for the Establishment of economic Zones	Oct 2008 Jun 2010	Site Assessment, Review Master Plan, Environmental Impact Assessment, Cost Developments And Tender Works.	World Bank Ministry of Finance, Kuwait, Public Authority for Industry. Kuwait Foreign Investment Bureau	272	Master plan review, Environmental Impact Assessment & Costing.
Feasibility Studies (EIA) for The Establishment of Wood Recycling Plant.	May 2008 Jul 2010	<ul style="list-style-type: none"> - Establishment of a feasibility study and environment impact statement for the proposed Al-Wazzan wood recycling plant in Kuwait. - Feasibility Study Comparative advantage, Market Definition and Investor Demand relating to the recycling Wood Industry. - Policy, Legal, Regulatory and Institutional Framework. 	Al-Wazzan Company - Kuwait	30.6	Environmental Impact Assessment Studies & Management Feasibility Studies Financial Studies.
Environmental Impact Assessment Study for Urea Formal dehyde Plant (UFC).	Apr 2008	<ul style="list-style-type: none"> - Environmental impact assessment study for existing (UFC) plant; - Scope and methodology, data collection analysis and reporting in compliance with the General Policies and Objectives of the Environmental Protection Agency (EPA) in Kuwait. 	- Al-Wazzan Company. - ChemiKuwait - Industry, Kuwait	17	Revision of national laws, regulations and standards of environmental quality, emissions and health & safety procedures (EPA).

PMC PROJECTS - REFERENCES

Financial Centers

Project Name	Period From / To	Brief Description of Project	Client	Approx. value (in Million US\$)	PMC Role.
Burgan Bank New Headquarters Building.	Mar 2005 Sep 2005	Burgan Bank New Headquarters Building is a 32- Story Office Tower located in Sharq.	Burgan Bank, Sharq,- Kuwait.	68	Carrying out a comprehensive, technical audit, and contractual matters, including claim assistance.
The Central Bank of Kuwait - New Headquarters Facilities	Jul 2002 Feb 2010	The Central Bank of Kuwait - New Headquarters Facilities are an office tower situated in the Sharq area, Kuwait City. The Facility consists of a tower for offices with a total area of around 75,000m ² (three basements, a ground floor and 41 floors above ground level), and a multistory car park facility (three basements, a ground floor and four floors above ground level) with total area of around 65,000m ² .	Central Bank of Kuwait - Kuwait.	544	Program Management, Project Control, Planning and Scheduling, Design Management, to Management, and Construction Management.
Al Ahliya Insurance company Headquarter.	1993 1996	The headquarters building for Al Ahliya Insurance is a 12-storey facility located at Ahmad Al Jaber Street in Kuwait City.	Al Ahliya Insurance Co. - Kuwait	23.8	Complete Project Management Services, including Design and Construction, Contract Management and Control,

PMC PROJECTS - REFERENCES

Health Care Projects

Project Name	Period From / To	Brief Description of Project	Client	Approx. value (in Million US\$)	PMC Role.
The Kilani Health Care Institute Project	Dec 2010 Nov 2014	Commercial (Health Care Facilities) A Health Care Institute with more than 80 beds - 1 Operation floor inclusive of one Hybrid Operation Room. -1 Radiology Floor. Total build-up area is 33,457 m ² and incorporating more than 80 beds distributed over 5 floors.	Dr. Zaid Kilani - Farah Hospital, Amman, Jordan	64.6	Pre-Construction Management Construction Management.
Medical Services and Clinic Building for National Guard	Aug 2010 Apr 2012	Medical Services and Clinic Building for National Guard Headquarters comprises of 4-floor and is located towards the North-West of Kuwait.	Kuwait National Guard - Kuwait.	3.06	Environmental Management. Environmental Impact Assessment Study. Feasibility Study. Financial Study.
General Headquarters Dental Clinic Building in the Liberation Camp for National Guard	Jun 2010 Jul 2011	Dental Clinic Building in the Liberation Camp for National Guard is located towards the South West of Kuwait (South Surra) It comprises of 3 floors.	National Guard, South Surra, - Kuwait	2.65	Environmental Management. Environmental Impact Assessment Study. Feasibility Study. Financial Study.
Renovation of Ahmadi Hospital	2007 2008	Ahmadi Hospital is situated 3km from center of Ahmadi City, 4.80 km from King Fahed Motorway and 3.7 km away from the KOC/DIGTC facility. The hospital was renovated and additional wards were added, including an entrance hall, a new dental clinic, and an overall upgrading of the infrastructure.	Kuwait Oil Company (KOC) Ahmadi, - Kuwait	23.8	Design Enhancement and Construction Management.

PMC PROJECTS - REFERENCES

Governmental Institutions

Project Name	Period From / To	Brief Description of Project	Client	Approx. value (in Million US\$)	PMC Role.
Solar Photovoltaic	Sept 2015 Oct 2017	Solar Photovoltaic Energy to 150 Kuwaiti homes as a supplemental power generation.	Kuwait Institute for Scientific Research (KISR). - Kuwait	0.714	Project Management/ Consultancy Services.
Kuwait International Airport	1996 2002	The Project includes Facilities Design and Civil Works, Meteorological Systems, Operations and Air Navigation Equipment, Complete upgrade and new construction of control, Aviation Systems and related facilities.	The Directorate General of Civil Aviation. – Kuwait.	272	Complete Program, Management, Design, Construction Management & Control. Contract Administration.
Kuwait University	1992 1998	The Kuwait University Program included various academic facilities, comprised of: lecture halls, amphitheatres, exhibition halls, sports complex, conference halls, cafeterias, central kitchen, laboratories, and parking. It also included renovation of existing school facilities, landscaping, college of arts, infrastructure, Community and neighborhood center, administration and library building.	Kuwait University	761.6	Complete Program Management Services.

PMC PROJECTS - REFERENCES

Hotels & Recreational Centers

Project Name	Period From / To	Brief Description of Project	Client	Approx. value (in Million US\$)	PMC Role.
Development of 17 Rest Houses along the Causeways	May 2010 Aug 2012	PMC is responsible for all stages of the transaction, from initial feasibility study, to strategy development and up to calling for Expression of Interest (EOI), PMC developed Financial Models for the project, assessed the level and form of public sector financial support for the project, and revise and finalized a draft Construction and Operating Agreement for selection of investors.	Kuwait Authority for Partnership Projects (KAPP) – Kuwait.	34	Technical Assessment and Evaluation. Feasibility Advisory. Services. Market Assessment. Financial Advisory Services. Strategic Environmental Impact Assessment Contract Documents.
Dreams Buildings Project- Bouznika in Morocco	Aug 2009 Jul 2011	Dreams Buildings Project is a mixed usage development for hotel, residential and leisure. It is located on a land site of 61,860 m ² site; located on Casablanca-Rabat Highway facing the Atlantic Ocean.	Dream Buildings SA. Bouznika - Morocco	31	Design and Construction Management Services.
Dead Sea Resort Spa and Hotel Facility. Dead Sea, Jordan	Feb 2005 May 2007	Sports, Leisure and Entertainment Facility. The Dead Sea Resort and SPA Project is comprised of 16 clusters units (single rooms, duplexes and suites). Each cluster has its own swimming pool and pool outlets (pool bars, snack outlets).The site was fragmented into 6 areas served by 3 complete main facilities.	Grand Real Estate, - Kuwait.	112.2	Concept Design and complete EPCM services.
Hard Rock Cafe	Oct 2003 May 2004	The Hard Rock Café Kuwait is located in the Salmiya area, in the heart of the main shopping and nightlife district of Kuwait. Positioned a few meters from the sea and housed in a standalone glass pyramid facility and seats 347 guests and is designed to overlook the sea.	The Hard Rock Company. - Kuwait	3.4	Design concept and fast track CM and Risk Management.
Al Kheiran Resort Renovation Work	1992 1993	The Project is located at the Al Kheiran area, approx. 90km South of Kuwait. The renovation works included site clearance, removal of debris, structural repair works, roofing works, wall finishes, ceiling finishes, floor finishes, aluminum and glazing works, landscape and irrigation works, electrical and mechanical repair works.	Touristic Enterprises Company, Al Kheiran, Kuwait	20.4	Complete Project Management.
Sheraton Hotel	1989 1992	Renovation works on the hotel started prior to invasion of State of Kuwait and later expanded to include repair of damages caused during the occupation period.	Oriental Hotel Co. -Kuwait	17	Project Management of design and construction of the complete refurbishment program.

PMC PROJECTS - REFERENCES

Residential - Commercial Buildings

Project Name	Period From / To	Brief Description of Project	Client	Approx. value (in Million US\$)	PMC Role.
Al-Seef High Rise Facility	Jul 2008 May 2009	The project is located in Al-Seef area, one of the major retail attractions in Bahrain, near the Al-Seef mall. The project consists of 3-level car parking, space, rentable office tower and serviced residential units.	A'ayan Real Estate Co. - Kuwait.	13.6	Design Management and Review Services.
The Lofts Residential Complex	Apr 2008 May 2010	The Complex has a unique panoramic view of Fahaheel Expressway and consists of 20 floors (lofts). The Building includes one and two room apartments/ studios with recreational amenities.	A'ayan Real Estate Co. - Kuwait.	18.7	Design Management and Review.
Sarah Residential Complex.	2003 2006	Sarah complex is a residential complex located at Mahboula area, South of Kuwait city. The complex is comprised of 183 apartments units with and 38 furnished Studios. It has several support facilities such as two external retail shop units, a health club with a swimming pool for adults and children, saunas, two squash courts, two gymnasiums, laundry, snooker and games lobbies, tennis and basketball courts. Also has a total of 83 car park spaces and 122 storerooms at basement level.	ARTAAL Realty, - Kuwait	34	Complete Project Management.
Nasser Residential & Commercial Complex. High Rise Facility	2003 2006	Nasser Tower is a residential complex located at Fintas area opposite to E'gaila beach, South of Kuwait city. The complex is comprised of 136 apartment units and a health club that includes a swimming pool for adults and children. The complex has an external retail shop and two basement levels of parking.	ARTAAL Realty, - Kuwait	20.4	Project Management of the design and construction of the complete refurbishment program.

Contact us



إدارة ومتابعة المشاريع ذ.م.م.

Project Management and Control w.l.l.

A member of PMC International Ltd.

**COMPANY PROFILE
2025**

Project Management and Control w.l.l - Kuwait

Fahed Al-Salem Street, Salhia Tower, 7th Floor,

P.O.Box: 23598, Safat: 13096, Kuwait

Tel: +965 2241 4571/ 81 /2245 3549,

Fax: +965 2245 3548

Email: info@pmc.com.co

www.pmc.com.co



إدارة ومتابعة المشاريع ذ.م.م.
Project Management and Control w.l.l.
A member of PMC International Ltd.